



Learjet 31A/ER

The Learjet 31 series of airplanes is essentially a Learjet 35 with a new 4 foot longer wing with almost four-foot high winglets instead of wingtip fuel tanks and large “delta fins” attached to the tail cone. These changes made the plane a much more docile one to fly, greatly improved field lengths and added 6 kts. to its normal cruise speed. Seats full range decreased to 1,225 nm. plus NBAA IFR fuel reserves. The Learjet 31 won its Supplemental Type Certificate (STC) in 1988. The 31A got its STC in 1991.

The 31A has a 1,450 pound higher Ramp Weight for more payload with full fuel. The Learjet 31A/ER has an optional extended range kit installed which adds 275 nm. to the airplanes range.



ESTIMATED VARIABLE COSTS - Per Hour

	Learjet 31	Learjet 31A	Learjet 31A/ER
Fuel (1)	\$1,258.46	\$1,258.46	\$1,258.46
Fuel Additives			
Lubricants			
Maintenance Labor (2)	231.57	231.57	231.57
Parts Airframe/Eng/Avion (3)	154.13	154.13	154.13
Engine Restoration (4)	442.62	438.52	438.52
Thrust Reverser Allowance			
Propeller Allowance			
APU Allowance			
Major Periodic Maintenance			
Misc Exp. - Landing/Parking	15.29	16.97	17.46
- Crew Expenses	64.94	64.94	64.94
- Supplies/Catering	30.90	30.90	30.90
- Carbon Offset (5)			
- Other			
Fractional Fuel Surcharge Cost/Hour + Tax			
Fractional Cost/Hour + Tax			
Total Variable Cost/Hour	\$2,197.91	\$2,195.49	\$2,195.98
Cost per Nautical Mile	\$5.28	\$5.28	\$5.28
Average Speed-Kts. (6) 600-nm trip	416.00	416.00	416.00

Cost data in this report is intended to be used as a benchmark

FOOTNOTES - Size of Operation: 1 - 2 Aircraft

Date: 4/6/2011

Currency: \$

Type of Operation:	Corporate	Corporate	Corporate
1. Fuel Cost	6.23	6.23	6.23
Gallons/Hour Blk Fuel/Flt Time +15%	202	202	202
2. Maint. Labor Cost per Hour	93	93	93
Maint. Hours/Flight Hours	2.49	2.49	2.49
3. Incl. Engine Parts Cost	No	No	No
Engine Model	TFE 731-2	TFE 731-2	TFE 731-2
Aircraft Model Year	1991	2003	2003
4. Overhaul Cost Source	JSSI Prem10	JSSI Prem10	JSSI Prem10
5. CO2 Cost Per Tonne			
6. Block Speed Source	Mftr Data	Mftr Data	Mftr Data



ANNUAL FIXED COSTS

	Learjet 31	Learjet 31A	Learjet 31A/ER
Crew salaries - Captain (7)	\$88,000	\$88,000	\$88,000
- Co Pilot	52,000	52,000	52,000
- Flt Attendant			
- Flt Eng/Other			
- Benefits	42,000	42,000	42,000
Hangar - Typical	28,000	28,000	28,000
Insurance - Hull (8)	6,000	12,000	13,125
Single Limit Liability	10,500	10,500	10,500
Recurrent Training	23,600	23,600	23,600
Aircraft Modernization (9)	45,000	30,000	30,000
Navigation Chart Service	4,579	4,579	4,579
Refurbishing (10)	16,740	16,740	16,740
Computer Mx. Program (11)	4,500	4,500	4,500
Weather Service (12)	700	700	700
Other Fixed Costs			
Mgmt Fee/Yr			
Total Fixed Cost/Year	\$321,619	\$312,619	\$313,744

Cost data in this report is intended to be used as a benchmark

FOOTNOTES - Size of Operation: 1 - 2 Aircraft

Date: 4/6/2011

Currency: \$

7. Crew Salary Source	10 NBAA	10 NBAA	10 NBAA
Number of Crew	2	2	2
8. Ins Hull Value/Frac Share Cost	1,200,000	2,400,000	2,625,000
Hull Insurance Rate (%)	0.50	0.50	0.50
9. Modernization	10 Yr Avg	10 Yr Avg	10 Yr Avg
10. Refurbish Labor Hrs/Seat	30	30	30
11. Comp. Mx Program Source	Typical	Typical	Typical
12. Weather Service Source	Typical	Typical	Typical



ANNUAL BUDGET

	Learjet 31	Learjet 31A	Learjet 31A/ER
Utilization - Nt. Miles	175,000	175,000	175,000
- Hours	421	421	421
Variable Cost	925,320	924,300	924,507
Fixed Cost	321,619	312,619	313,744
Total Cost (No Depreciation)	\$1,246,939	\$1,236,920	\$1,238,251
- Per Hour	2,962.00	2,938.00	2,941.00
- Per Nt. Mile	7.13	7.07	7.08
- Per Seat Nt. Mile	1.19	1.18	1.18
Total Cost (No Depreciation)	1,246,939	1,236,920	1,238,251
Book Depreciation (13)	120,000	240,000	262,500
Total Cost (Book Dep)	\$1,366,939	\$1,476,920	\$1,500,751
- Per Hour	3,247.00	3,508.00	3,565.00
- Per Nt. Mile	7.81	8.44	8.58
- Per Seat Nt. Mile	1.30	1.41	1.43
Total Cost (No Depreciation)	1,246,939	1,236,920	1,238,251
Market Depreciation (14)	48,000	96,000	105,000
Total Cost (Market Dep.)	\$1,294,939	\$1,332,920	\$1,343,251
- Per Hour	3,076.00	3,166.00	3,191.00
- Per Nt. Mile	7.40	7.62	7.68
- Per Seat Nt. Mile	1.23	1.27	1.28

Cost data in this report is intended to be used as a benchmark

Footnotes - Size of Operation: 1 - 2 Aircraft

Date: 4/6/2011

Currency: \$

13. Book Depreciation Rate	10% per yr	10% per yr	10% per yr
14. Market Depreciation Rate	4.00	4.00	4.00



GENERAL COMPARISON

	Learjet 31	Learjet 31A	Learjet 31A/ER
Cabin-Height (Ft.)	4.35	4.35	4.35
- Width	4.95	4.95	4.95
- Length	12.90	12.90	12.90
Cabin volume (Cu. Ft.)	268.00	271.00	261.00
Cabin Door Height (Ft.)	4.16	4.16	3.75
- Width	3.00	3.00	3.00
Baggage -Int. (Cu.Ft.)	30.00	40.00	30.00
- External			
Typical Crew/Pass Seating	2/6	2/6	2/6
Weight-Max Take-off (Lbs.)	15,500	17,200	17,700
- Maximum Landing	15,300	16,000	16,000
- Basic Operating	11,203	11,203	11,247
- Usable Fuel	4,124	4,124	4,653
Payload-Full Fuel (Lbs.)	243	1,873	2,000
- Maximum	1,397	2,297	2,253
Certified	Yes	Yes	Yes
IFR Certified	Yes	Yes	Yes
Price - New (Corporate)/1000	4,525	6,525	6,650
- Pre Owned Rng/1000	1,000/1,200	1,400/2,400	1,625/2,625
- Years Produced	1988 - 1991	1991 - 2003	1991 - 2003

PERFORMANCE COMPARISON

	Learjet 31	Learjet 31A	Learjet 31A/ER
Range-NBAA IFR Res (N.Mi.)			
Seats Full	1,211	1,211	1,480
Ferry Range - (Pilot(s) only, no pax)	1,337	1,337	1,600
Range-30 Min. Res (N.Mi.)			
Seats Full			
Ferry Range - (Pilot(s) only, no pax)			
Balanced Field Length (Ft.)	3,800	3,800	3,800
Landing Field Length - FAR 121	4,200	4,200	4,200
Rate Of Climb (Ft/Min)	5,480	5,110	4,890
- One Engine Out	1,890	1,610	1,515
Cruise Speed-Max (KTAS)	462	462	462
- Normal	441	441	441
- Long Range	417	417	417
Stall Speed (IAS)	87	87	87
Ceiling-Service MTOW (Ft.)	46,200	46,200	46,200
- Service OEI	31,200	26,200	25,000
- Certified	51,000	51,000	51,000
- Hover IGE (Helicopter Only)			
- Hover OGE (Helicopter Only)			

INTERIOR

Scale = 1:30

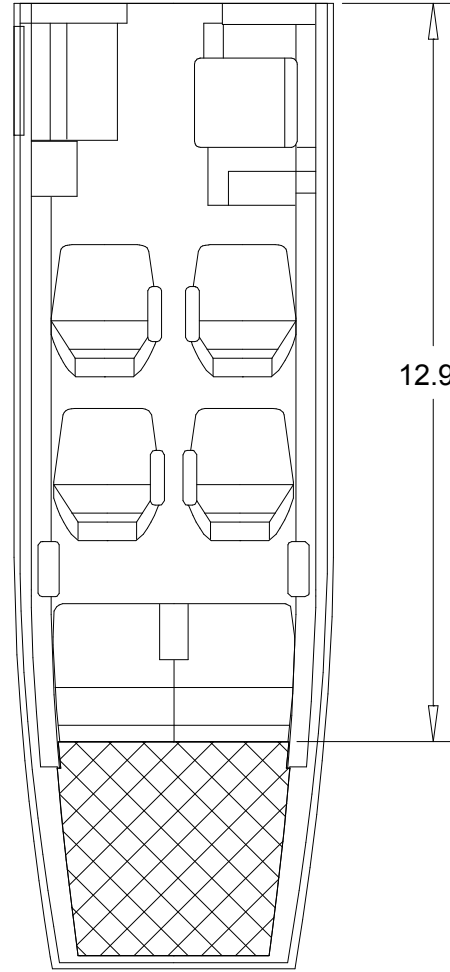
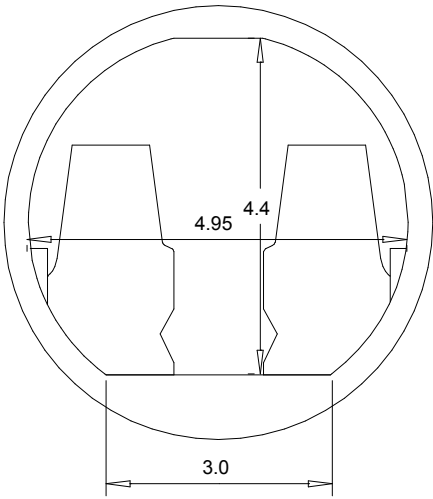

Learjet 31

Scale = 1:40

 - Baggage

All dimensions are measured in Feet unless otherwise specified.

EXTERIOR

Scale = 1:120

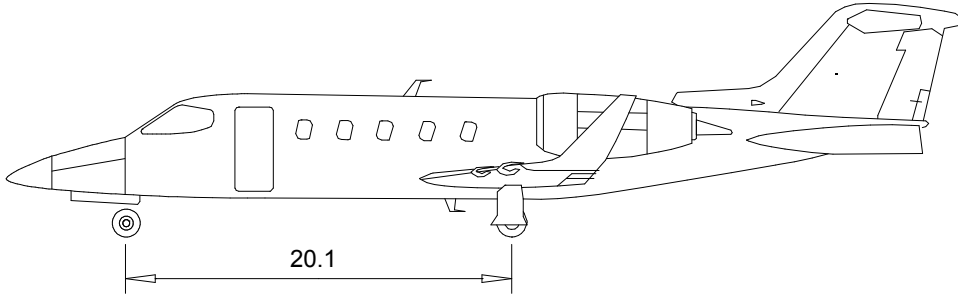

Learjet 31

Orleans, Massachusetts (508)255-5975

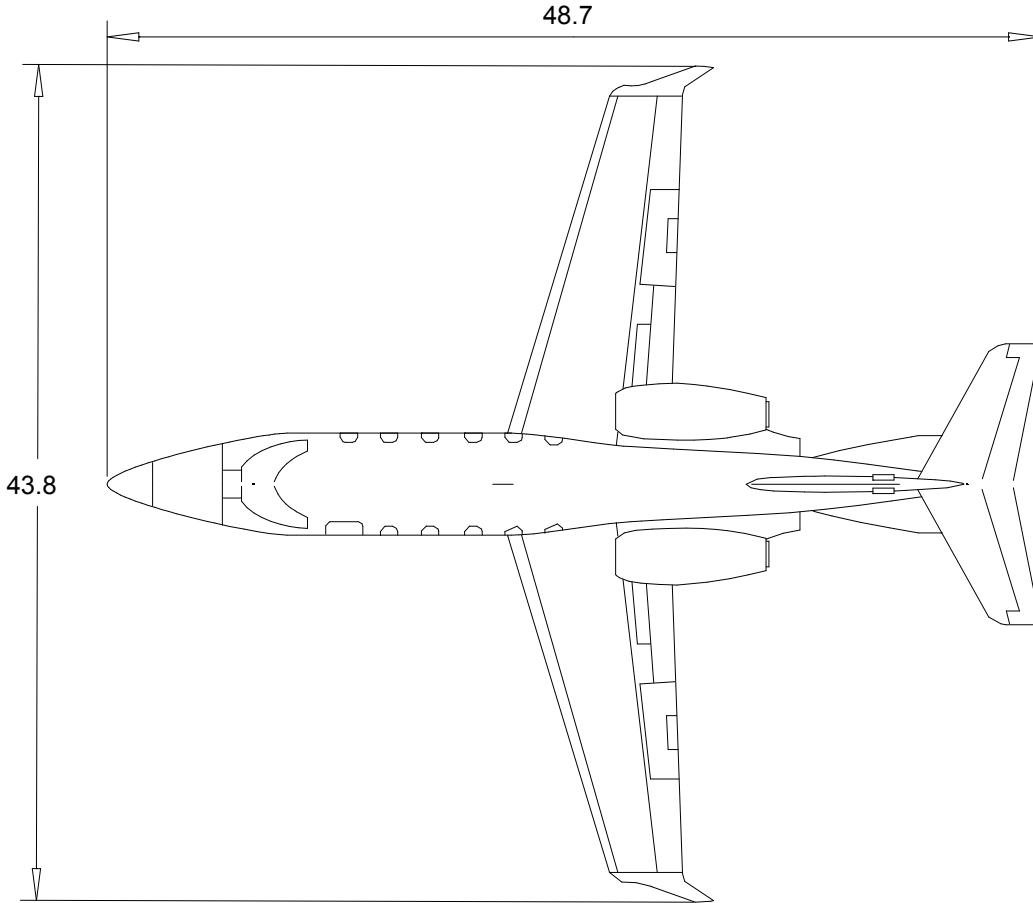

© 2006 Conklin & de Decker Associates, Inc.

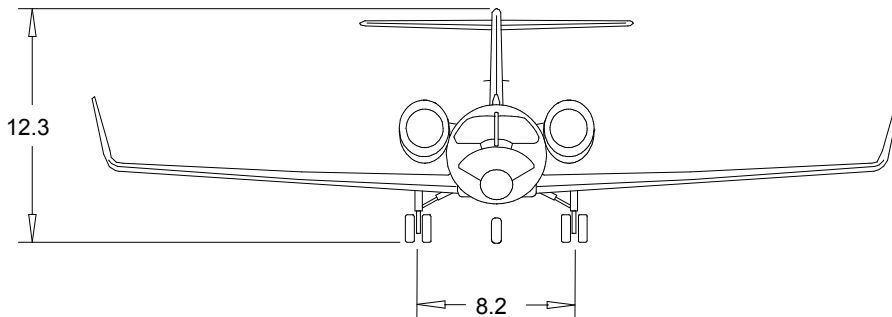

All dimensions are measured in Feet unless otherwise specified.